

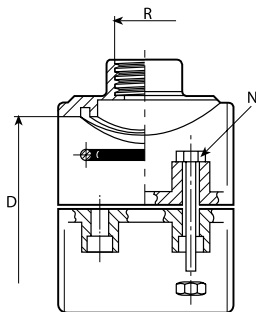

ΣΕΛΛΑ PN10
CLAMP SADDLE PN10



Κωδικός Code	D-R Ø Σπείρωμα Thread	N Βίδες Screws	Τμχ/Κουτί Pcs/Box
7601020	20-1/2"	2	150
7601025	25-1/2"	2	180
7601026	25-3/4"	2	180
7601032	32-1/2"	2	140
7601033	32-3/4"	2	140
7601034	32-1"	2	140
7601040	40-1/2"	2	110
7601041	40-3/4"	2	110
7601042	40-1"	2	110
7601050	50-1/2"	2	80
7601051	50-3/4"	2	80
7601052	50-1"	2	80
7601053	50-1 1/4"	2	80
7601063	63-1/2"	4	55
7601064	63-3/4"	4	55
7601065	63-1"	4	55
7601066	63-1 1/4"	4	55
7601067	63-1 1/2"	4	55
7601075	75-1/2"	4	40
7601076	75-3/4"	4	40
7601077	75-1"	4	40
7601078	75-1 1/4"	4	40
7601079	75-1 1/2"	4	40
7601080	75-2"	4	40
7601090	90-1/2"	4	30
7601091	90-3/4"	4	30
7601092	90-1"	4	30
7601093	90-1 1/4"	4	30
7601094	90-1 1/2"	4	30
7601095	90-2"	4	30

Κωδικός Code	D-R Ø Σπείρωμα Thread	N Βίδες Screws	Τμχ/Κουτί Pcs/Box
7601109	110-1/2"	4	19
7601110	110-3/4"	4	19
7601111	110-1"	4	19
7601112	110-1 1/4"	4	19
7601113	110-1 1/2"	4	19
7601114	110-2"	4	19
7601115	110-2 1/2"	4	35
7601125	125-3/4"	4	12
7601126	125-1"	4	12
7601127	125-1 1/4"	4	12
7601128	125-1 1/2"	4	12
7601129	125-2"	4	12
7601130	125-2 1/2"	4	35
7601140	140-1"	6	25
7601141	140-1 1/4"	6	25
7601142	140-1 1/2"	6	25
7601143	140-2"	6	25
7601144	140-3"	6	15
7601160	160-1"	6	13
7601161	160-1 1/4"	6	13
7601162	160-1 1/2"	6	13
7601163	160-2"	6	13
7601164	160-3"	6	9
7601165	160-4"	6	9
7601199	200-1"	6	11
7601200	200-1 1/4"	6	11
7601201	200-1 1/2"	6	11
7601202	200-2"	6	11
7601203	200-3"	6	9
7601204	200-4"	6	8
7601225	225-1"	6	6
7601226	225-1 1/4"	6	6
7601227	225-1 1/2"	6	6
7601228	225-2"	6	6
7601229	225-3"	6	6
7601230	225-4"	6	6
7601250	250-1"	6	4
7601251	250-1 1/4"	6	4
7601252	250-1 1/2"	6	4
7601253	250-2"	6	4
7601254	250-3"	6	4
7601255	250-4"	6	4
7601315	315-1"	6	3
7601316	315-1 1/4"	6	3
7601317	315-1 1/2"	6	3
7601318	315-2"	6	3
7601319	315-3"	6	3
7601320	315-4"	6	3