



ΣΦΑΙΡΙΚΗ ΒΑΝΑ, PN16
2-WAY BALL VALVE, PN16



Seats: **PE** | O-rings: **EPDM**

NEW

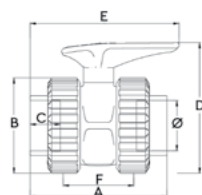

| Κωδικός Code | DN | A | B | C | D | E | F | PN | Ø |
|-----------------|-----|-----|-----|----|-----|-----|-----|----|-----|
| 1011078 | 40 | 149 | 99 | 31 | 142 | 169 | 77 | 16 | 50 |
| 1011079 | 50 | 173 | 121 | 38 | 165 | 188 | 90 | 16 | 63 |
| 1011080 | 65 | 215 | 151 | 45 | 222 | 281 | 121 | 10 | 75 |
| 1011081 | 80 | 255 | 175 | 51 | 244 | 301 | 141 | 10 | 90 |
| 1011682 | 100 | 267 | 210 | 61 | 307 | 426 | 155 | 10 | 110 |

ΣΦΑΙΡΙΚΗ ΒΑΝΑ ΜΕ ΘΗΛΥΚΟ ΣΠΕΙΡΩΜΑ, ΤΥΠΟΣ PE, PN10
BALL VALVE WITH BSP FEMALE THREAD, TYPE PE, PN10



Seats: **HDPE** | O-rings: **EPDM**

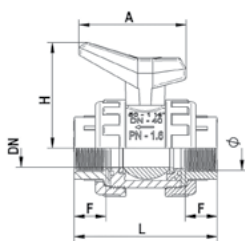

| Κωδικός Code | DN | A | F | H | L | Ø | Τμχ/Κουτί Pcs/Box |
|-----------------|-----|-----|----|-----|-----|--------|----------------------|
| 1020016 | 10 | 61 | 14 | 55 | 95 | 3/8" | 48N |
| 1020020 | 15 | 61 | 16 | 55 | 95 | 1/2" | 48N |
| 1020025 | 20 | 61 | 19 | 58 | 102 | 3/4" | 48N |
| 1020032 | 25 | 82 | 22 | 77 | 115 | 1" | 30N |
| 1020040 | 32 | 82 | 26 | 81 | 130 | 1 1/4" | 36I |
| 1020050 | 40 | 110 | 31 | 107 | 144 | 1 1/2" | 24I |
| 1020063 | 50 | 110 | 38 | 113 | 166 | 2" | 16I |
| 1020075 | 65 | 152 | 44 | 152 | 224 | 2 1/2" | 6J |
| 1020090 | 65 | 152 | 51 | 152 | 232 | 3" | 6J |
| 1020091 | 80 | 152 | 61 | 163 | 246 | 3" | 6L |
| 1020110 | 100 | 277 | 61 | 180 | 307 | 4" | 4K |

ΣΦΑΙΡΙΚΗ ΒΑΝΝΑ ΜΕ ΑΡΣΕΝΙΚΟ ΣΠΕΙΡΩΜΑ, ΤΥΠΟΣ PE, PN10
BALL VALVE WITH THREADED MALE BSP, TYPE PE, PN10



Seats: **HDPE** | O-rings: **EPDM**

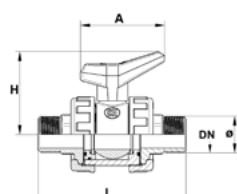

| Κωδικός Code | DN | A | F | H | L | Ø | Τμχ/Κουτί Pcs/Box |
|-----------------|----|-----|----|-----|-----|--------|----------------------|
| 1022050 | 40 | 110 | 29 | 107 | 189 | 1 1/2" | 14K |
| 1022063 | 50 | 110 | 30 | 113 | 226 | 2" | 22K |